

1. Put on clean gloves and remove a twin (HiSCC) cartridge from packaging

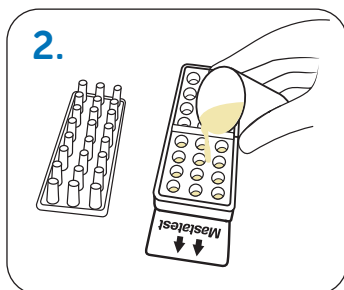

2. Remove cartridge lid and place upside down. Half-fill chamber 1 with milk sample 1.

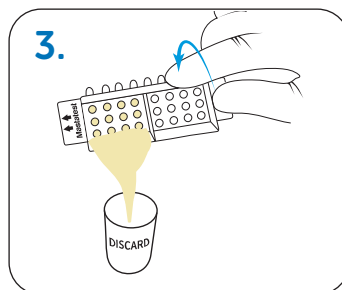

3. Pour off surplus milk from chamber 1 and discard

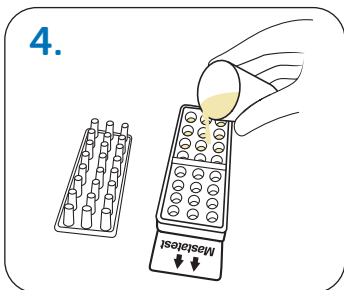

4. Half-fill chamber 2 with milk sample 2

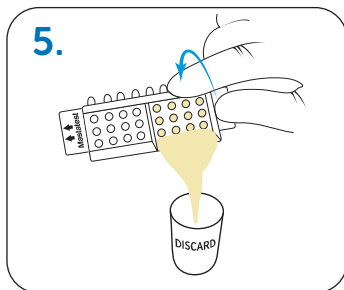

5. Pour off surplus milk from chamber 2 and discard

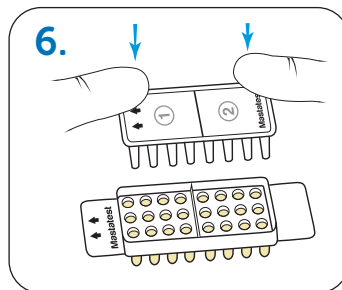

6. Replace lid, ensuring the arrows align with those on the base. Press down firmly to close.

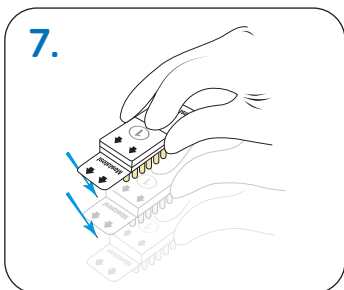

7. Tap firmly 2-3 times, repeating if air-bubbles are visible in the wells

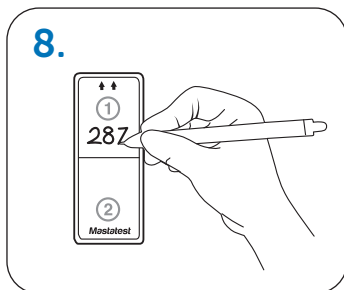

8. Label cartridge lid with correct cow numbers for samples 1 and 2

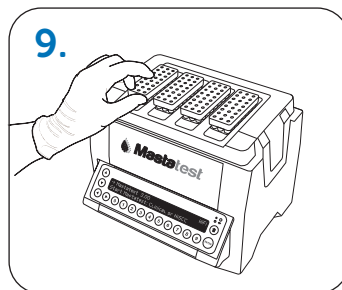



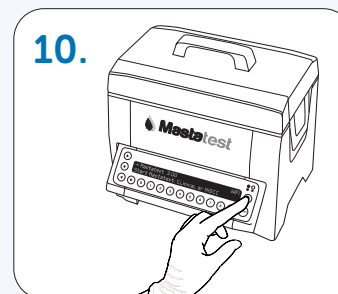

9. Insert cartridge into Lapbox with the arrows facing to the back, and replace the lid









Start a Mastatest®





To Begin:

- From the Lapbox main menu, select **Start Mastatest** 
- Select Lapbox position used: If first free position used , or scroll  to select and 

Option 1: BoxStart

- Scroll down  to select **HiSCC** 
- Select **Boxstart** 
- Input cow numbers (e.g 00123) and scroll  to select quarter  for sample 1. Repeat for sample 2.
- Confirm Start 

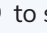
Option 2: QuickStart

- Scroll down    to select **QuickSCC** 
- Input test details to vetoquinol.mastatestsystem.com as soon as possible

Next steps:

- Countdown timer shows remaining time.
- Results emailed within 24 hrs
- Further tests can be started independently



vetoquinol-mastatest.com/how-to-use

Deutsch, Français, English, Español, Italiano, Portuguese, Polski, Nederlands